

4

3

2

1

REVISIONS			
LTR	DESCRIPTION	DATE	APPROVED
B	REVISED PER ECN T-013154		

NOTES:

1. MATERIAL:
- A) BACKSHELL COPPER ALLOY 172 PER QQ-A-533.
 - B) BACKSHELL SCREW STAINLESS STEEL PER QQ-S-763, 300 SERIES
 - C) CLAMP BAR STAINLESS STEEL PER QQ-S-766, 300 SERIES
 - D) INSERT ALUMINUM ALLOY PER QQ-A-356
 - E) CLAMP SCREW STAINLESS STEEL PER QQ-S-763, 300 SERIES
 - F) BUSBAR COPPER ALLOY 172 PER QQ-A-533

2. FINISH:
- A) BACKSHELL CADMIUM PLATED PER QQ-P-416
 - B) BACKSHELL SCREW CADMIUM PLATED PER QQ-P-416
 - C) CLAMP BAR CADMIUM PLATED PER QQ-P-416
 - D) INSERT CADMIUM PLATED PER QQ-P-416
 - E) CLAMP SCREW CADMIUM PLATED PER QQ-P-416
 - F) BUSBAR SOLDER PLATED PER MIL-P-81728

3. RAYCHEM PART NUMBER CHA-0223 AND DATE CODE ARE STAMPED APPROXIMATELY AS SHOWN.

4.

AVAILABLE WIRE AND SolderQuik® MATCHES	
WIRE NUMBER	SolderSleeve® NUMBER
MS 27500 24 SE1G23	D-100-0066
MS 27500 22 SE1G23	D-110-0066
MS 27500 24 SE2G23	D-110-0056
MS 27500 22 SE2G23	D-110-0056
MS 27500 24 SE3G23	D-110-0056
MS 27500 22 SE3G23	D-110-0056
MS 27500 24 SE4G23	D-110-0056
MS 27500 22 SE4G23	D-110-0056

SOLDER SLEEVES® TO BE PURCHASED SEPERATELY.

5. WEIGHT: .057 LBS - 25,85 GRAMS MAXIMUM.

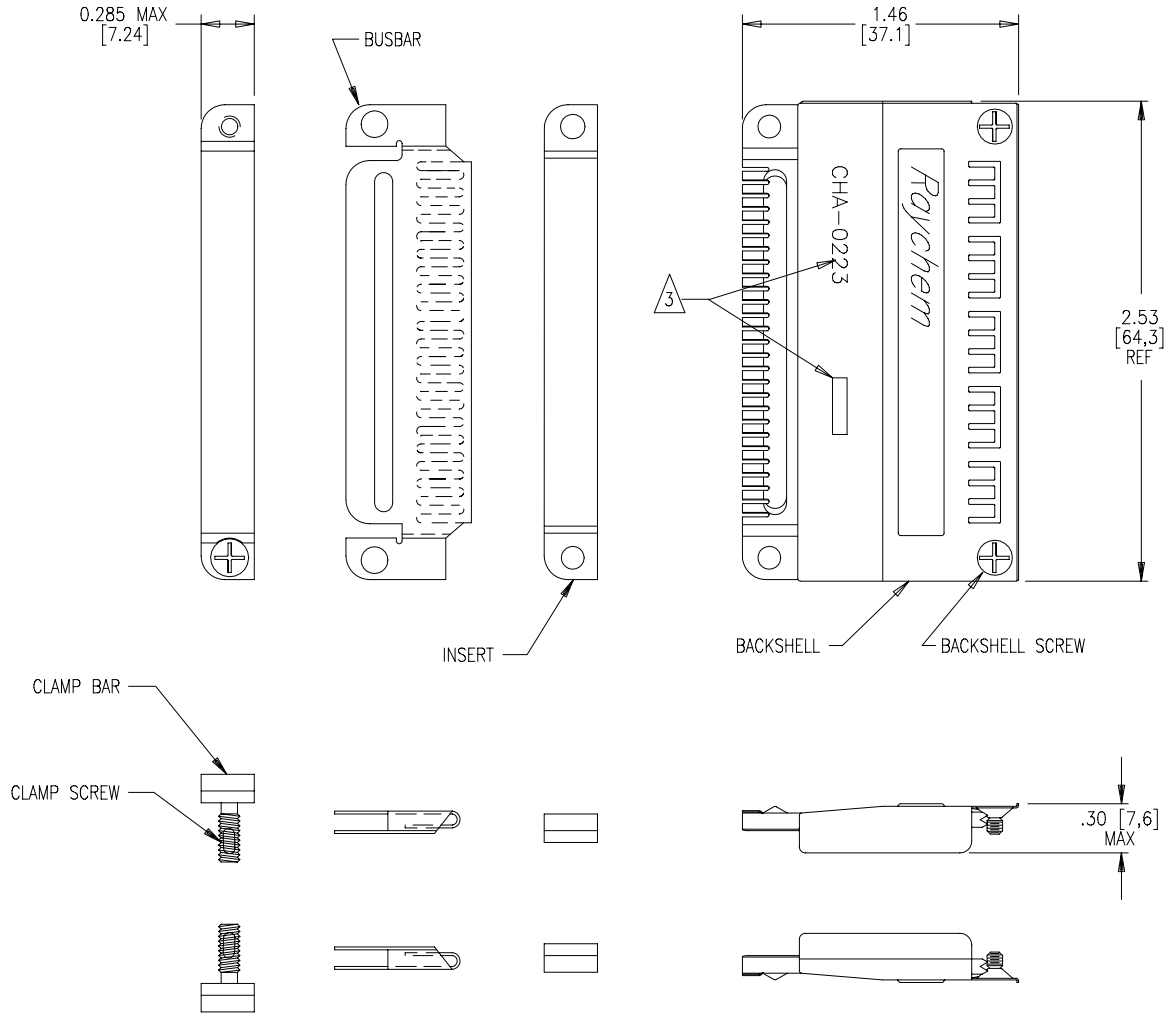

SPECIFICATION CONTROL DRAWING © Raychem Corporation 1989

UNLESS OTHERWISE SPECIFIED DIMENSIONS ARE IN INCHES. METRIC DIMENSIONS ARE IN BRACKETS. DECIMALS .XXX ± .005 [.13mm] .XX ± .02 [.5mm] ANGLES .X ± WEIGHT: MAXIMUM .0923lbs. [1.866g.]	DRAWN	LUTTICKEN	891111	Raychem RAYCHEM CORPORATION 300 CONSTITUTION DRIVE MENLO PARK, CALIFORNIA 94025			
	CHECKED					TITLE	
	APPROVED	J.BLAIR	88NOV3	BACKSHELL, RECEPTACLE, 2", EME, CADMIUM PLATED SHIELDED PLANAR-ARRAYED CABLES MTC SERIES			
	APPROVED	J.CAMERON	88NOV11				
	CAD NAME		005236-1	SIZE	CODE IDENT. NO.	DWG. NO.	REV
	THIRD ANGLE PROJECTION			C	06090	CHA-0223	B
				DO NOT SCALE THIS DRAWING		SHEET 1 OF 1	

If this document is printed it becomes uncontrolled.
Check with the web for latest revision.

4

3

2

1

SHEET 1
CHA-0223
DWG. NO.